



**What once was old
is Barn Again...**



Layout and Buildings

Early Settlement





RESIDENCE OF JOSEPH M. MILLER,
SEC. FARMINGTON TOWNSHIP, DODGE CO., IOWA.



RESIDENCE OF W. B. WHITE, SEC. 13, TOWN OF FARMINGTON, GILMSTED CO., MISS.



RESIDENCE OF SVEND NELSON,
ROCK GULL TWP., GILMSTED CO., MISS.



Layout and Buildings

Early through
1930's

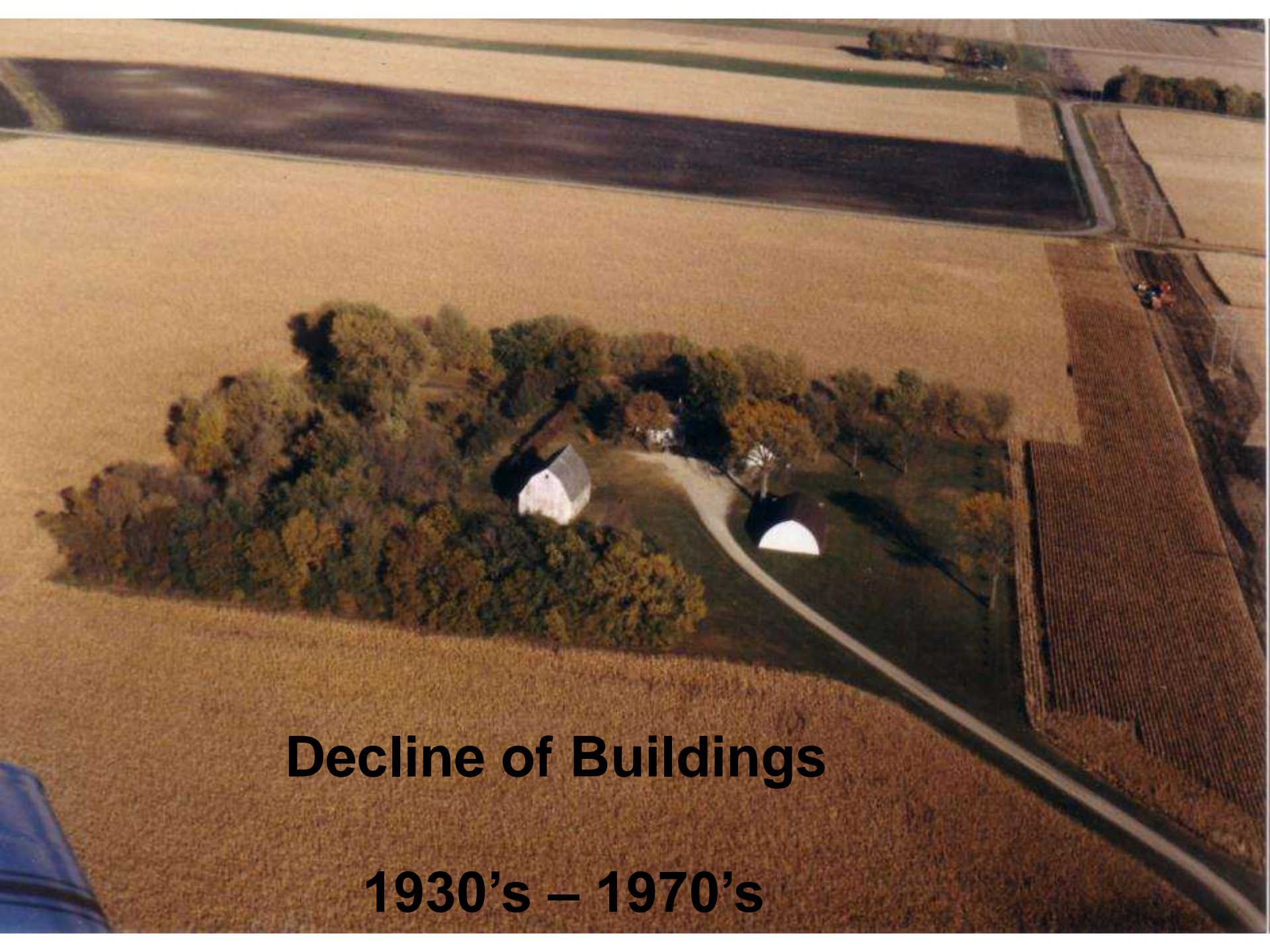

Decline of Buildings

1930's – 1970's

Layout and Buildings

Where's the Barn?





Why More Than One Barn On A Farm?



Barn Evolution

Barn evolution

As Minnesota agriculture expanded from subsistence farming into larger, commercial ventures, barns and other farm buildings grew in scope to meet the new spatial demands of larger dairy and beef herds, as well as grain and silage storage. Barn design was ultimately altered by

the widespread use of manufactured trusses and balloon framing and the gradual abandonment of the timber-frame. The demise of the all-wood barn became final when the pre-fabricated pole barn became popular after World War II.

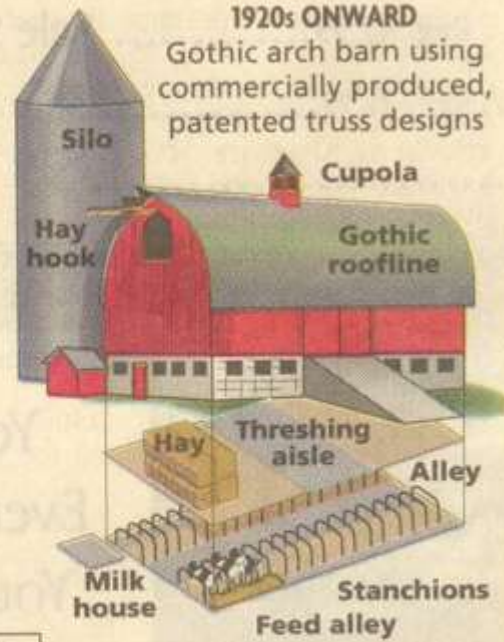

EARLY SETTLERS, 1800s
Double-crib log barn



1870s ONWARD
English 3-bay threshing barn with timber-framed gable roof



1890s-1920s
English 3-bay threshing barn, timber-framed gambrel roof

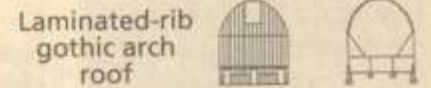

THE BONES OF POST-AND-BEAM CONSTRUCTION

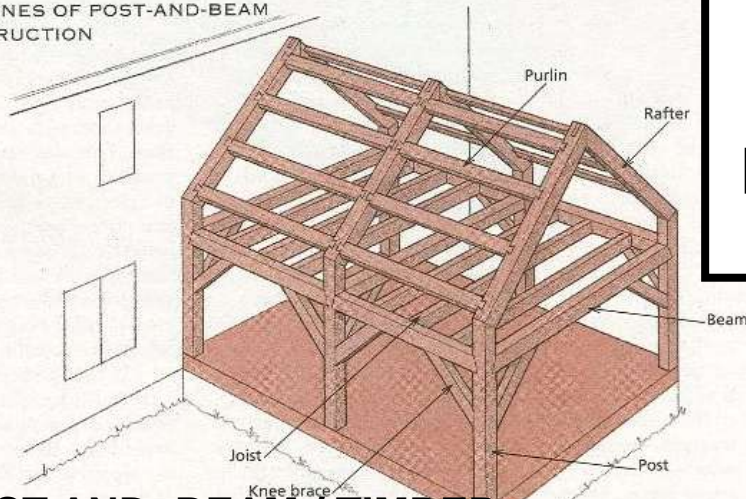

INSIDE FRAMING

CONVENTIONAL FRAMING

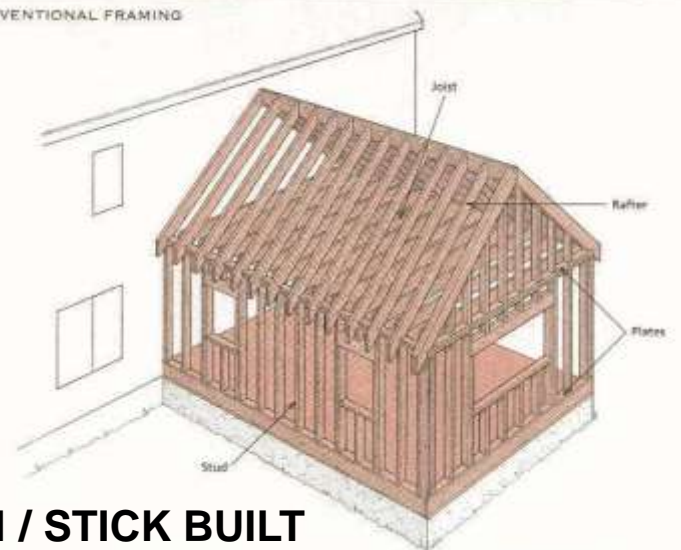

POST AND BEAM / TIMBER

BALLOON / STICK BUILT

SUPPORTED
(at Purlin)

HEAVY TIMBER
(Hewn Or Sawn Into
Square Members & Formed
Into Bents)

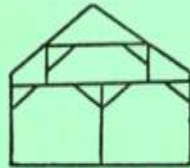

Solid Post & Beam
(Settlement - 1910s)

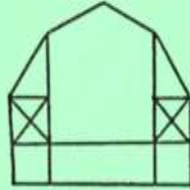

Open Center/Wing Joist # 1
(1880s - 1910s)

PLANK FRAMING
(Dimension Lumber
Formed Into Bents)

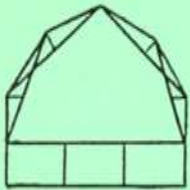

Shawver Truss
(1880s - 1930s)

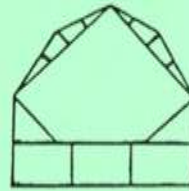

Iowa Truss/
Clyde Truss
(1923 - 1940s)



Roof Support – Change over Time



SELF-SUPPORTED

LIGHT TRUSS
(Balloon Frame--
Each Rafter &
Stud Share Loads)

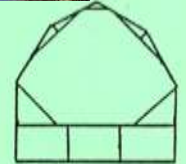

Braced Rafter/Wing Joist # 2
(1900s - 1940s)

LAMINATED
RAFTERS
(Sawed or Bent)

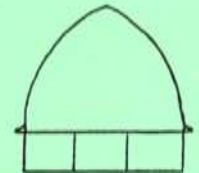

Gothic Arch
(1910s - 1950s)

Midwestern barns: roof-frame phases

ROOF STYLES

- SHED
- GABLE
- BROKEN GABLE
- GAMBREL
- GOTHIC ARCH / BOW TRUSS



TYPES OF BARNES

- 3 BAY THRESHING
- WESTERN
- DAIRY
- BANKED
- ROUND
- GOTHIC ARCH
- RAISED CENTER BAY
- TIMBER FRAMED
- BALLOON

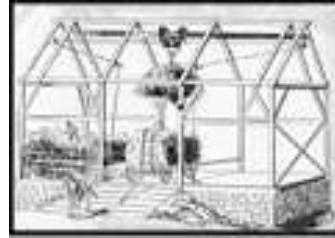

Barn Types in Minnesota

Barn Changes Over Time

Creation Of The American Barn

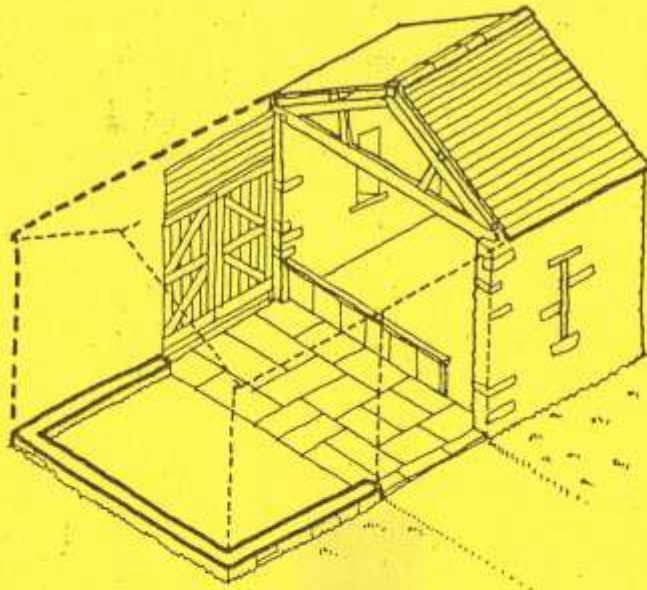

Fig. 3.2. Interior arrangement of a threshing barn.
Source: Brunskill, R. W., 1971.

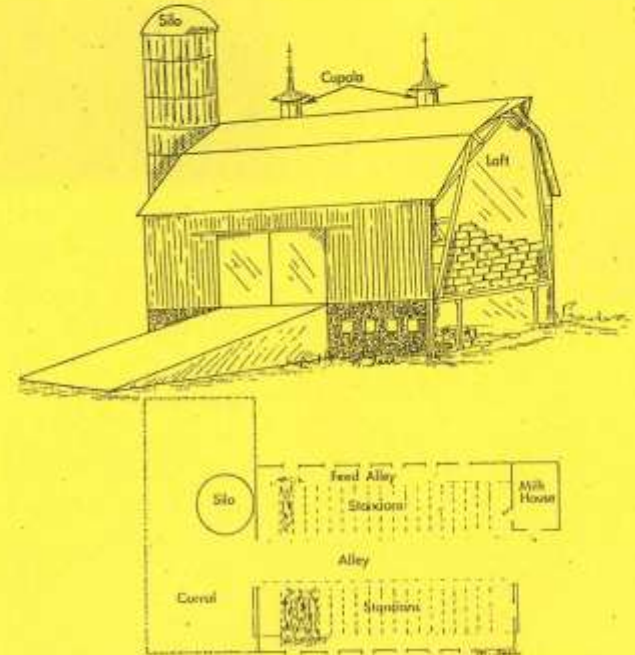
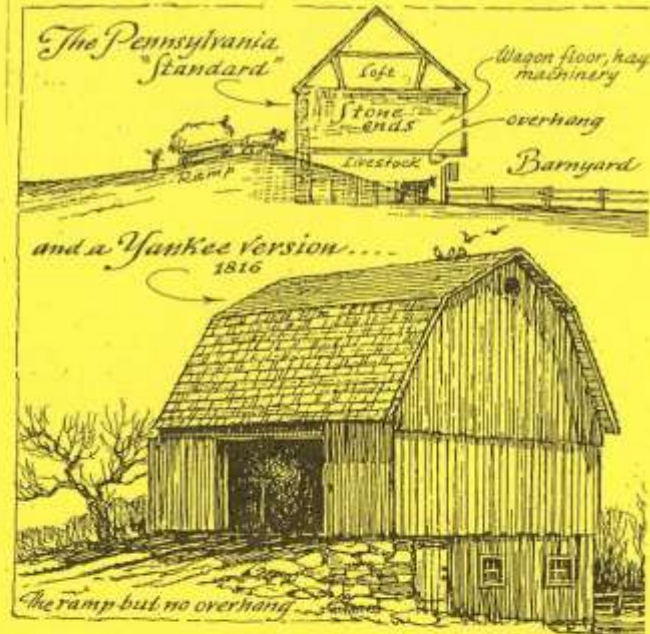
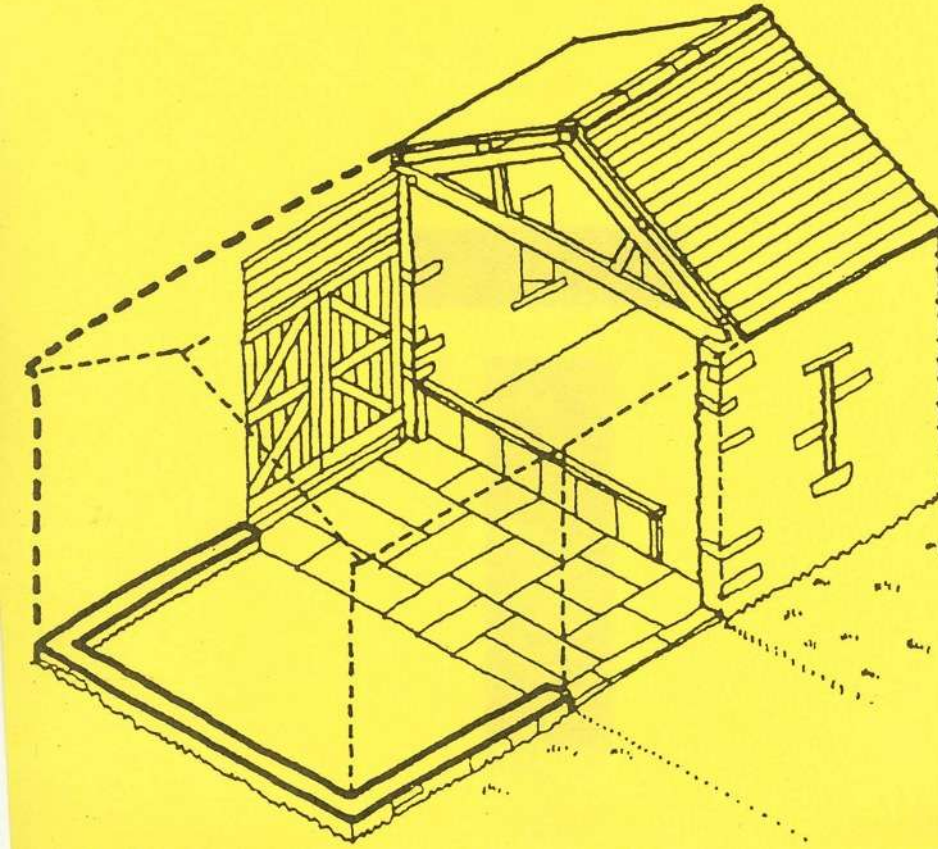
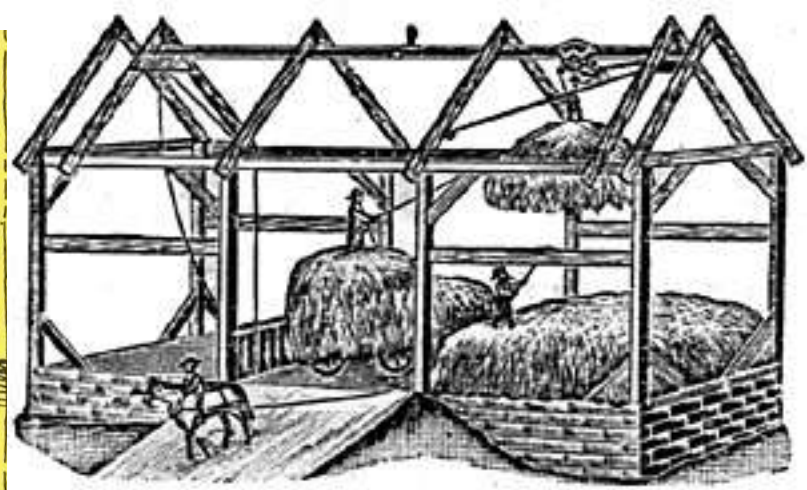
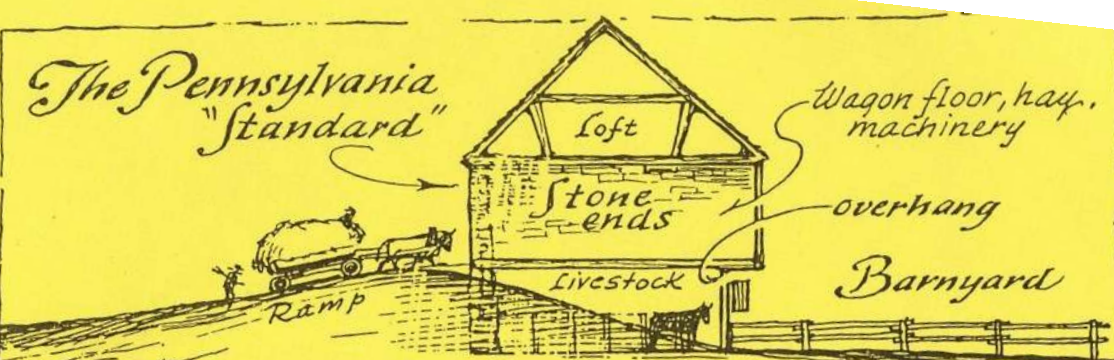

Fig. 6.3. Cut-away dairy barn and floor plan. Raised or basement barns are ideally suited for dairying. Hay from the upper stories is lowered through chutes to the cows below. The adjacent silo(s) provides the silage for winter feeding to maintain high milk production. Milk is collected via plastic pipes and stored in the milk house, which is attached at one end of the barn.

Threshing Barns

The Three-bay Threshing Barn





How Hay Changed the Barn

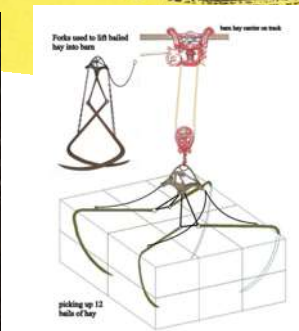
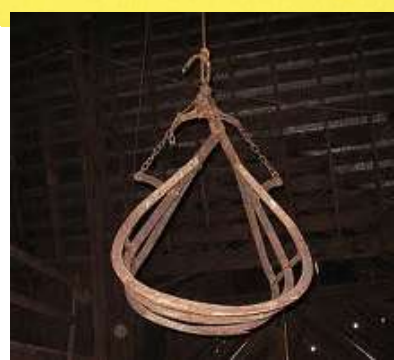
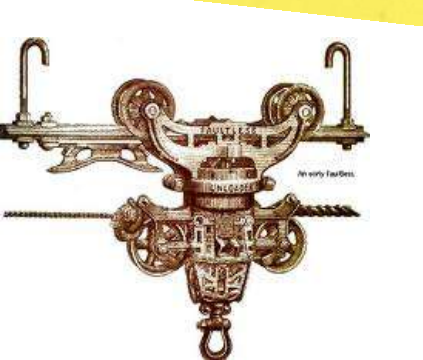

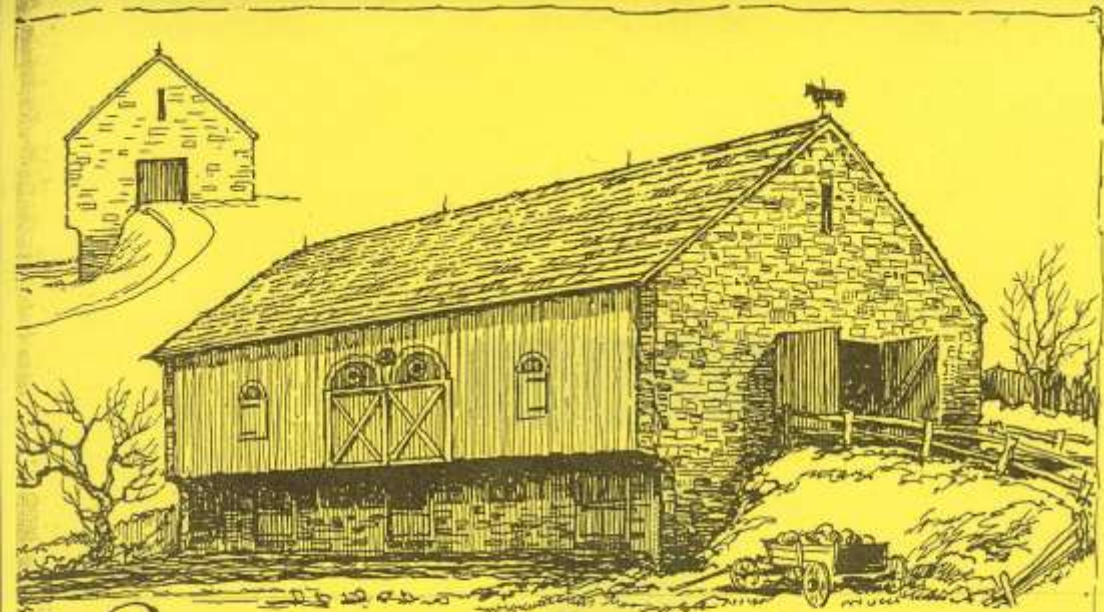

*in Pennsylvania the Barns are "banked a'hill,
stone to Weather"*

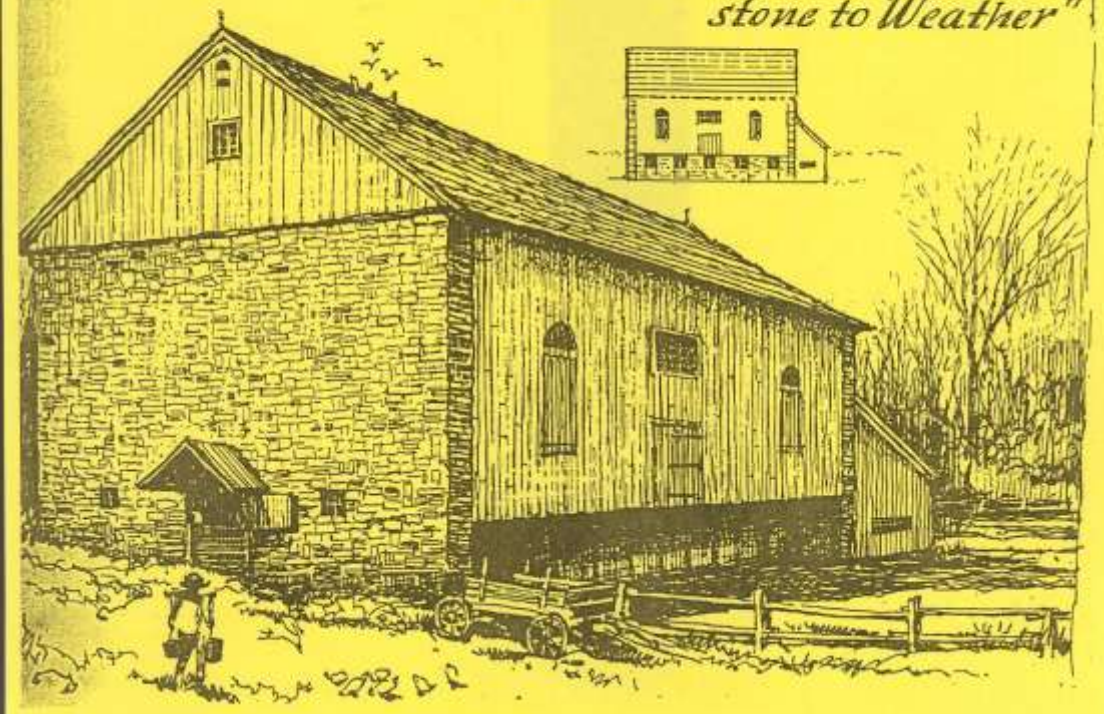

**-Banked -Ramped
-Birthing Barns**





RED & WHITE



KING EDWARD CIGARS



10

AAA

Coca-Cola

NORTHWESTERN

AAA



EXPANSION OF DAIRY BARNS

Profit-Material Availability-Transportation-Electricity

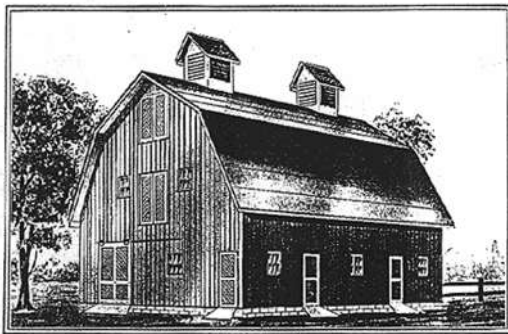
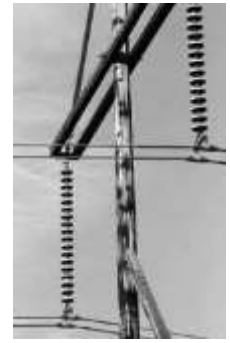

BARN No. 12

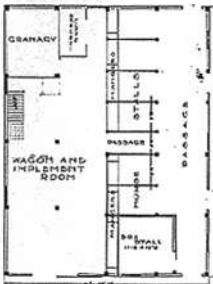

\$538⁰⁰

For \$538.00 we will furnish all the material to build this large Barn 36x46 feet, consisting of Rough Lumber, Framing Timbers, Plank Flooring, Shingles, Hardware, Sash and Paint, Hay Carrier Track and Rope.

By allowing a fair price for labor and cement blocks, which we do not furnish, this barn can be built for about \$520.00, including all material and labor.

For Our Free Offer of Plans See Page 1.

BARN No. 12 has six horse stalls, one large box stall 10 feet 8 inches by 11 feet 6 inches, and one room for wagons and implements, of sufficient size to drive into with a team and wagon. Granary on the first floor, also harness room. Stairway leading to the hay loft. The hay chute is placed in such a position that the hay may be thrown down to the first floor at a point from which it is but a few steps to any of the mangers.

Barns of the gambrel roof type permit of storing a greater amount of hay than the ordinary gable roof.

By using our 3/4-Ply Best-of-all Roofing or our 3/4-Ply Flint Surfaced Asphalt Roofing guaranteed to last twelve years, the total cost of material will be reduced \$40.00.

Built on a concrete block foundation. Sided with 10-inch plain boards, the joints being covered with molded battens.

Paint furnished for two coats outside, your choice of color.

For \$56.00 we will furnish all the material to build a lean-to shed, size 26x10 feet and 12 feet high, which can be built on one end of any barn shown in this book. Blue prints of this shed will be furnished free with the barn plans you order if requested.

SAVED \$200.00 ON A HOUSE BILL OF LUMBER. READ HIS REMARKS ABOUT QUALITY.

Sean, Roselock and Co., Chicago, Ill. Dear Sirs—about ten days ago I received a car of lumber from you, and upon its arrival I not only examined it, but nearly the whole town, to all of our surprise. I have used at least \$200.00 on my 200, besides I have the best grade. I will cheerfully recommend your lumber to anyone desiring to build, both in price and quality. Hoping to patronize you in the future, I remain, Yours very truly, P. J. CLAYBROCK.

SEARS, ROEBUCK AND CO.



CHICAGO, ILLINOIS



A milk-cooling tank, with cork insulation between inner and outer concrete walls and with electric refrigerating unit, constructed by an Ontario farmer.



Electric power in a rural electric factory.



Two 5-hp. motors operating a portable cream and separator in a summer-kitchen dairy.



Gambrel Roof Dairy Barns



BARN FEATURES.....

STACKING HAY.....

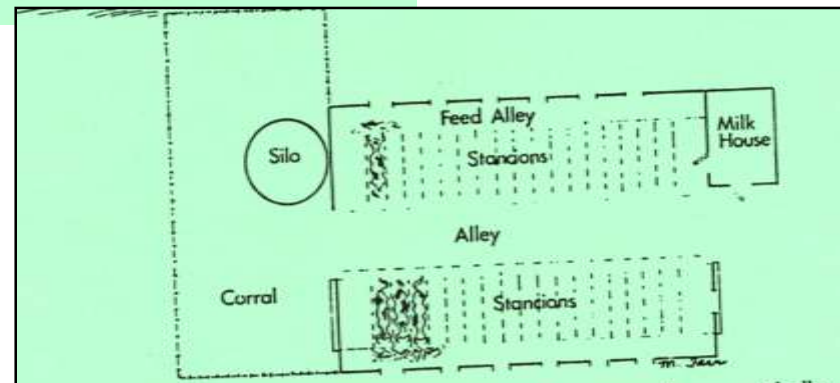
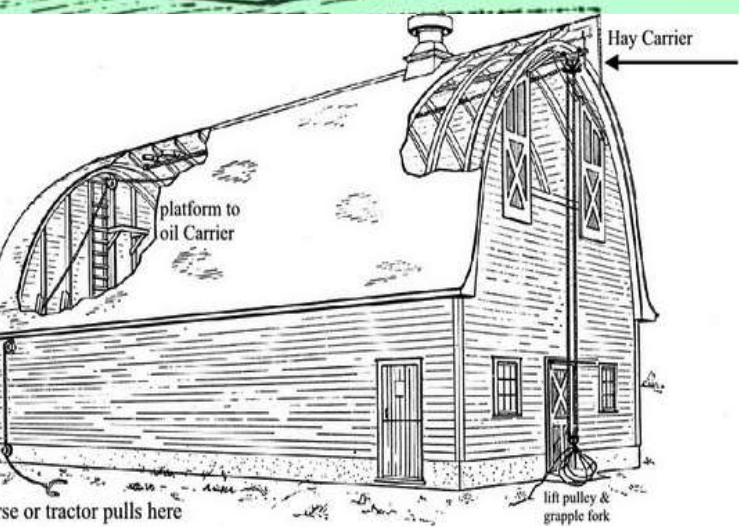
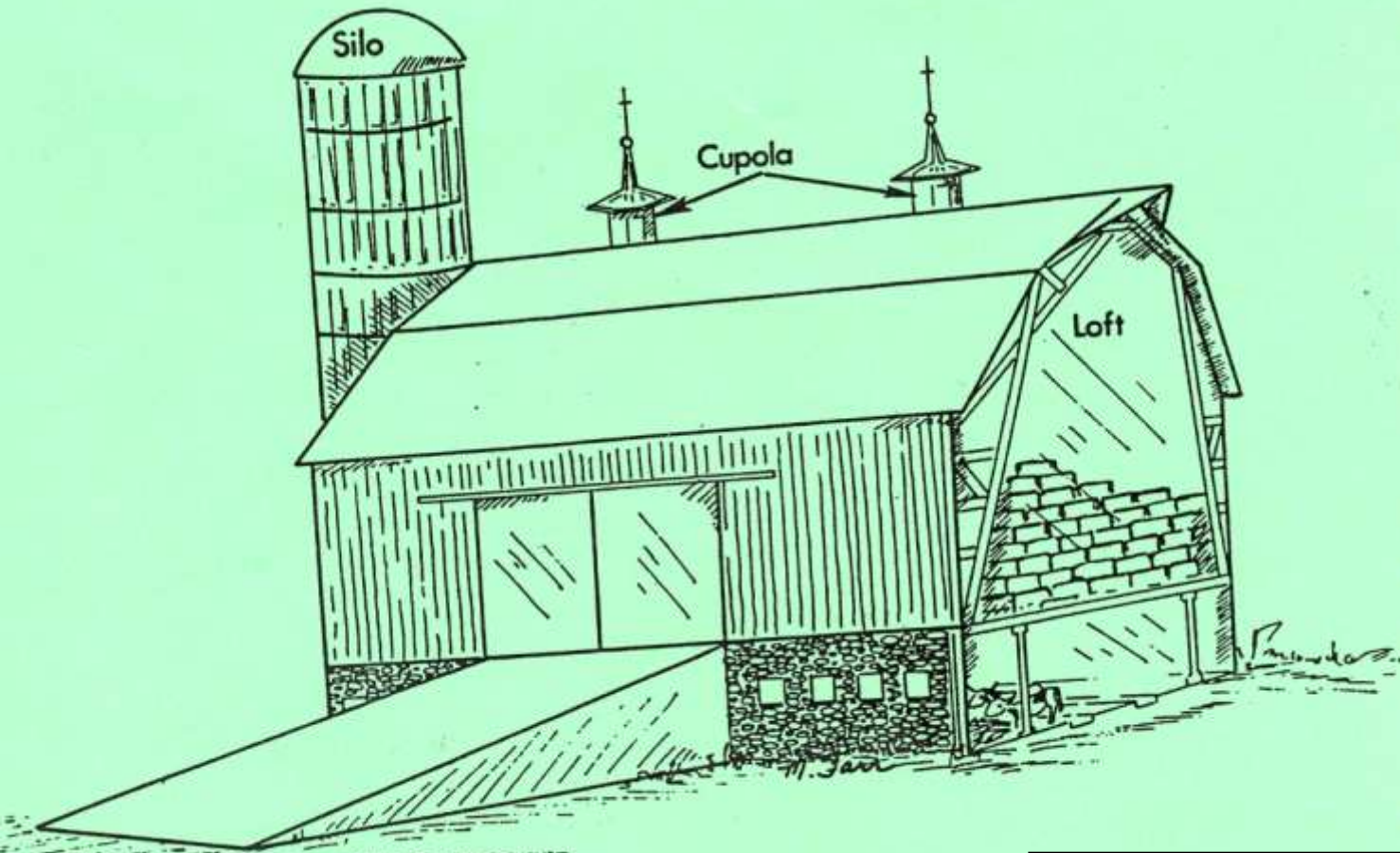

Fig. 6.3. Cut-away dairy barn and floor plan. Raised or basement barns are ideally suited for dairying. Hay from the upper stories is lowered through chutes to the cows below. The adjacent silo(s) provides the silage for winter feeding to maintain high milk production. Milk is collected via plastic pipes and stored in the milk house, which is attached at one end of the barn.



Western Barn

Raised Center Bay

Horse Barn





**Western -
Gable Roof
Broken Gable**





GOTHIC ARCH





Bow Truss / Gothic Arch Roof Dairy Barns



**ALREADY CUT \$530.00
AND FITTED
PRICE
AND UP**

**A Modern Barn with Gothic Roof
Construction
"Already Cut" and Fitted.**

Our "Gothic" barn features good appearance with strong construction and added strength from galvanized and zinc-plated materials. The roof is made of heavy, weather-resistant material, and the walls are made of heavy, weather-resistant material. The barn is built on a strong foundation and is designed to last for many years. The price is \$530.00 and up.

ALl fittings included in all of our "Gothic" barns. The price is \$530.00 and up. The barn is built on a strong foundation and is designed to last for many years. The price is \$530.00 and up.

THE "Gothic" barn is a modern barn with a strong appearance and added strength from galvanized and zinc-plated materials. The price is \$530.00 and up.

THE "Gothic" barn is a modern barn with a strong appearance and added strength from galvanized and zinc-plated materials. The price is \$530.00 and up.

THE "Gothic" barn is a modern barn with a strong appearance and added strength from galvanized and zinc-plated materials. The price is \$530.00 and up.



Prices of the "Gothic" Modern Barn No. 2226, "Already Cut" and Fitted.

Type	SIDE OF BARN			SIDE OF BARN			SIDE OF BARN		
	Length	Width	Height	Length	Width	Height	Length	Width	Height
10' x 12'	10'	12'	12'	10'	12'	12'	10'	12'	12'
12' x 14'	12'	14'	14'	12'	14'	14'	12'	14'	14'
14' x 16'	14'	16'	16'	14'	16'	16'	14'	16'	16'
16' x 18'	16'	18'	18'	16'	18'	18'	16'	18'	18'
18' x 20'	18'	20'	20'	18'	20'	20'	18'	20'	20'
20' x 22'	20'	22'	22'	20'	22'	22'	20'	22'	22'
22' x 24'	22'	24'	24'	22'	24'	24'	22'	24'	24'
24' x 26'	24'	26'	26'	24'	26'	26'	24'	26'	26'
26' x 28'	26'	28'	28'	26'	28'	28'	26'	28'	28'
28' x 30'	28'	30'	30'	28'	30'	30'	28'	30'	30'
30' x 32'	30'	32'	32'	30'	32'	32'	30'	32'	32'
32' x 34'	32'	34'	34'	32'	34'	34'	32'	34'	34'
34' x 36'	34'	36'	36'	34'	36'	36'	34'	36'	36'
36' x 38'	36'	38'	38'	36'	38'	38'	36'	38'	38'
38' x 40'	38'	40'	40'	38'	40'	40'	38'	40'	40'
40' x 42'	40'	42'	42'	40'	42'	42'	40'	42'	42'
42' x 44'	42'	44'	44'	42'	44'	44'	42'	44'	44'
44' x 46'	44'	46'	46'	44'	46'	46'	44'	46'	46'
46' x 48'	46'	48'	48'	46'	48'	48'	46'	48'	48'
48' x 50'	48'	50'	50'	48'	50'	50'	48'	50'	50'
50' x 52'	50'	52'	52'	50'	52'	52'	50'	52'	52'
52' x 54'	52'	54'	54'	52'	54'	54'	52'	54'	54'
54' x 56'	54'	56'	56'	54'	56'	56'	54'	56'	56'
56' x 58'	56'	58'	58'	56'	58'	58'	56'	58'	58'
58' x 60'	58'	60'	60'	58'	60'	60'	58'	60'	60'
60' x 62'	60'	62'	62'	60'	62'	62'	60'	62'	62'
62' x 64'	62'	64'	64'	62'	64'	64'	62'	64'	64'
64' x 66'	64'	66'	66'	64'	66'	66'	64'	66'	66'
66' x 68'	66'	68'	68'	66'	68'	68'	66'	68'	68'
68' x 70'	68'	70'	70'	68'	70'	70'	68'	70'	70'
70' x 72'	70'	72'	72'	70'	72'	72'	70'	72'	72'
72' x 74'	72'	74'	74'	72'	74'	74'	72'	74'	74'
74' x 76'	74'	76'	76'	74'	76'	76'	74'	76'	76'
76' x 78'	76'	78'	78'	76'	78'	78'	76'	78'	78'
78' x 80'	78'	80'	80'	78'	80'	80'	78'	80'	80'
80' x 82'	80'	82'	82'	80'	82'	82'	80'	82'	82'
82' x 84'	82'	84'	84'	82'	84'	84'	82'	84'	84'
84' x 86'	84'	86'	86'	84'	86'	86'	84'	86'	86'
86' x 88'	86'	88'	88'	86'	88'	88'	86'	88'	88'
88' x 90'	88'	90'	90'	88'	90'	90'	88'	90'	90'
90' x 92'	90'	92'	92'	90'	92'	92'	90'	92'	92'
92' x 94'	92'	94'	94'	92'	94'	94'	92'	94'	94'
94' x 96'	94'	96'	96'	94'	96'	96'	94'	96'	96'
96' x 98'	96'	98'	98'	96'	98'	98'	96'	98'	98'
98' x 100'	98'	100'	100'	98'	100'	100'	98'	100'	100'

Location:

Northeast of Underwood about 11 miles. West of Armor (CR 1) on CR 43 by 1.6 miles.

Otter Tail Co - MN

Latitude: N46 25.05

Longitude: W95 46.67

[Map](#)

Notes:

Round

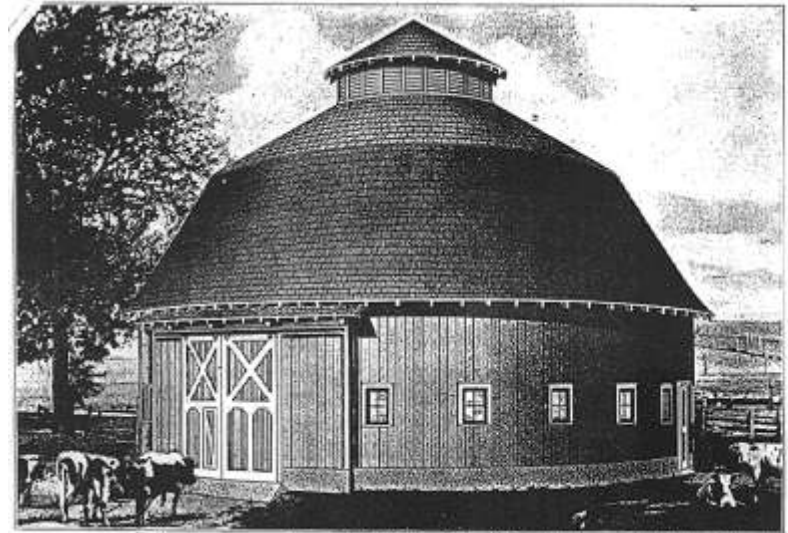

ALREADY CUT \$1,627.00 AND FITTED PRICE AND UP

A Round Barn, 60 Feet in Diameter, "Already Cut" and Fitted

THE floor plans on this page indicate the variety of uses to which this barn may be put. It may be used either as an exclusive dairy barn or as a barn for general purposes. In fact, the possibilities of the arrangement of the floor plan are unlimited. You will appreciate the features of the big driveway doors. Doors of most round barns are troublesome as they are usually cut and fitted on the job and best to the radius of the barn. We have departed from the old style of a curved driveway door and furnish straight sliding doors that will give satisfaction. The illustration shows our method and the good appearance of the barn thereby obtained.

The barn is to be built on a 3-foot concrete foundation. General floor height, 8 feet 6 inches. Sills, plates, girders and partitions are furnished "already cut" and fitted, ready to be nailed up on the job. Height from sill to eave, 16 feet.

All framing lumber is of No. 1 Yellow Pine. The outside walls are covered with double V vertical siding of cypress, "The Wood Eternal." This combination secures a very strong frame and outside walls that will withstand the weather for a lifetime.

The roof is covered with Extra Thick and Clear Red Cedar Shingles.

Prices of No. 2071 Round Barn, 60 Feet in Diameter, Total Height of Barn From Grade Line, 48 Feet. "Already Cut" and Fitted

Price, With No. 1 Common Cypress Siding.....\$1,627.00
 Price, With Select Cypress Siding..... 1,682.00

Doors are made of Clear Cypress, "The Wood Eternal." The large driveway doors slide on Roll-End Hangers, the highest priced hangers we handle. In one of the wings a breaker-hinged door for personal entrance is provided. Three more hinged doors for the entrance of stock are conveniently located. All doors are "ready-made" - ready to hang in place and are superior to doors produced by hand carpentry.

Hinged windows, opening size, 1 foot 10 1/2 inches by 3 feet 0 1/4 inches, are furnished.

Hardware, such as latches, bolts, screws, nails, etc., is included in the price, also sufficient paint for two coats, outside red for the body and white for the trim. You may select other combinations from our paint page (see page 47). Ventilating systems, cupolas, barn equipment, sills, foundation material, etc., are not included in the price.

Our "already cut" barns together with "ready-made" doors at the prices quoted make this round barn a good investment, at a great saving of time and labor. Free building plans, which are easy to understand, are furnished with every order. They show exactly where every piece fits.

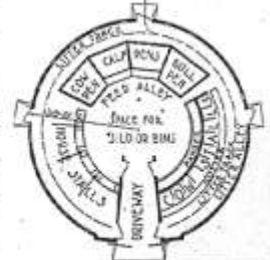
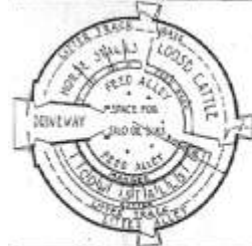

[MN Round Barn Page](#)
[Round Barns](#)

NEW BARNNS IN MINNESOTA

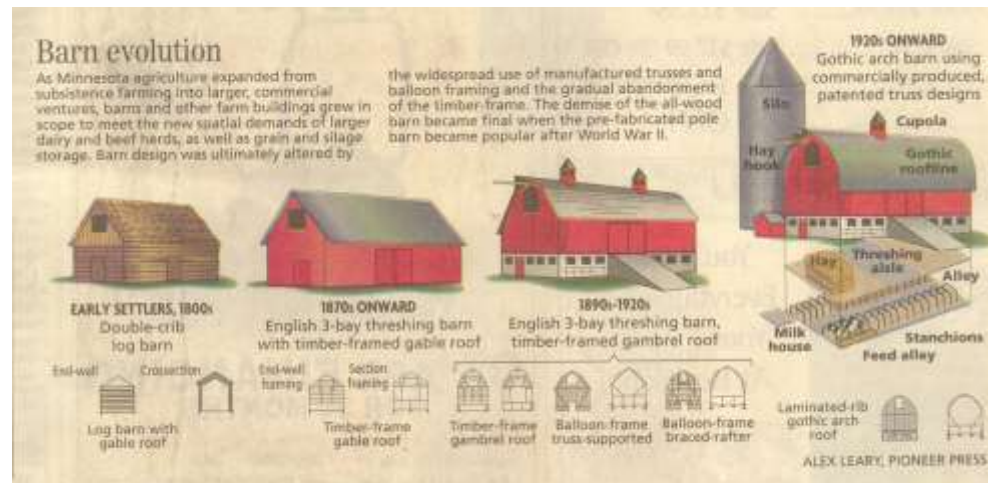



BARN MATERIALS

FOUNDATION

PAINT

ROOF

SIDING

INSIDE FRAMING

FLOORS

FOUNDATIONS

RUBBLE
FIELD STONE
DRESSED STONE
BRICK
CLAY TILE
CONCRETE BLOCK
POURED CONCRETE
POSTS
PIERS

CONTINUOUS WALL

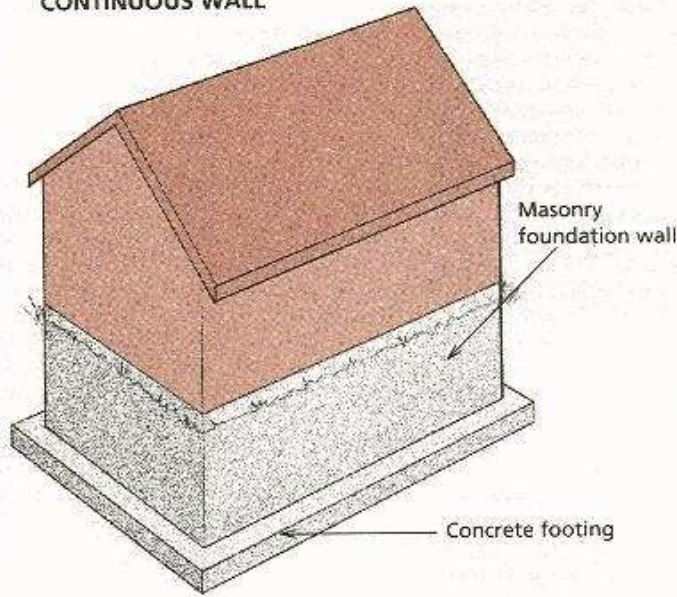

PIER

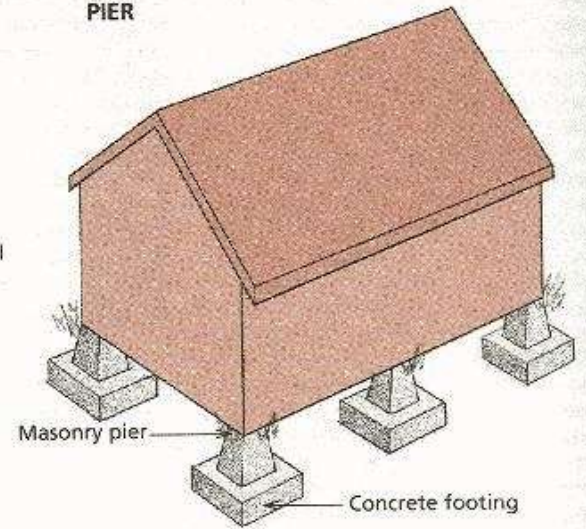

POLE

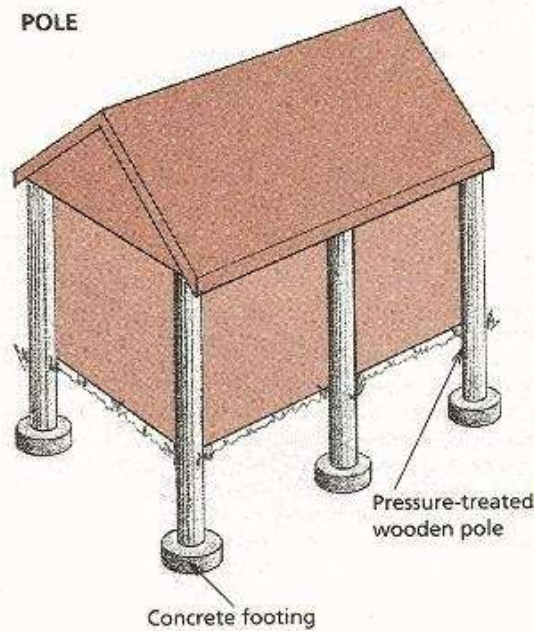

SLAB ON GRADE

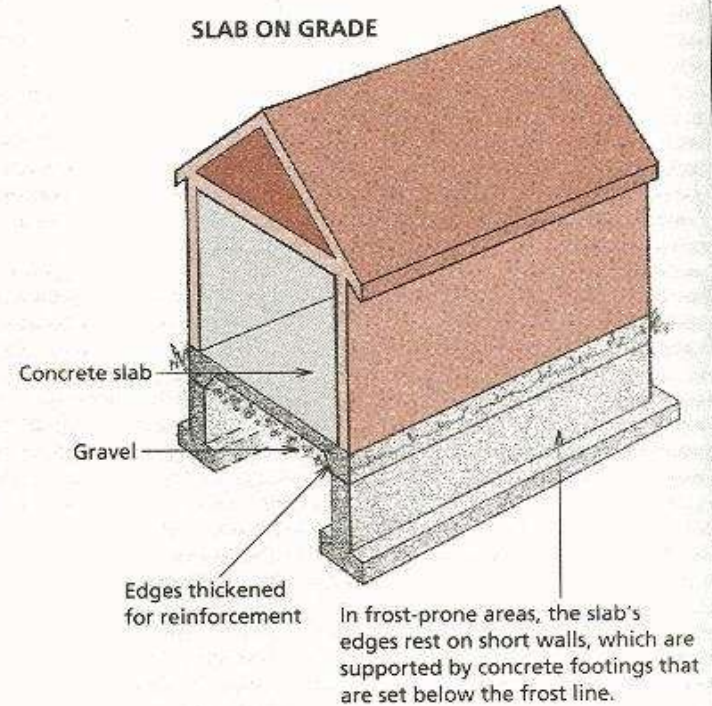

FOUNDATIONS



- RUBBLE
- FIELD STONE
- DRESSED STONE
- BRICK
- CLAY TILE
- CONCRETE BLOCK
- POURED CONCRETE
- POSTS
- PIERS

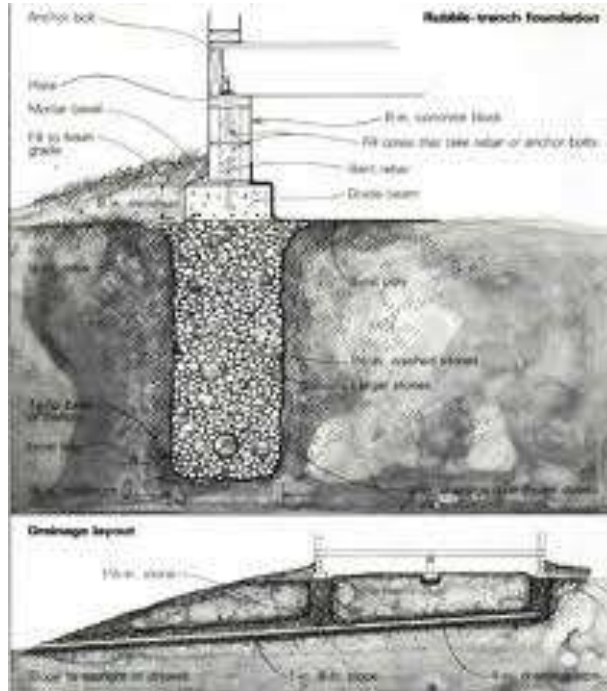
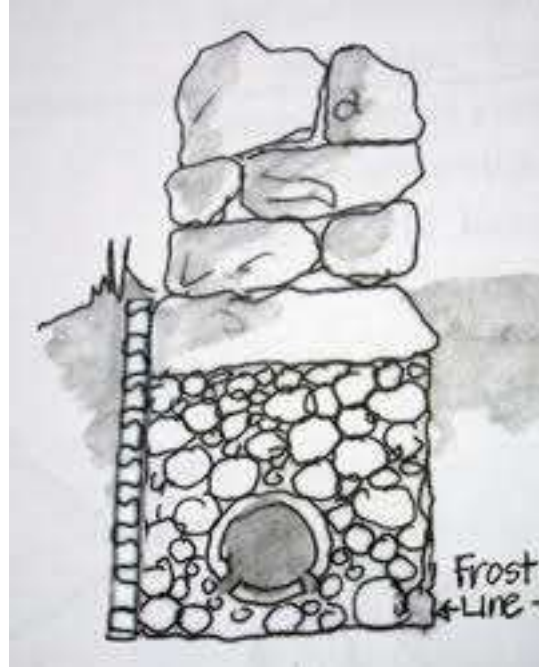

FOUNDATIONS

- RUBBLE
- FIELD STONE
- DRESSED STONE
- BRICK
- CLAY TILE
- CONCRETE BLOCK
- POURED CONCRETE
- POSTS
- PIERS

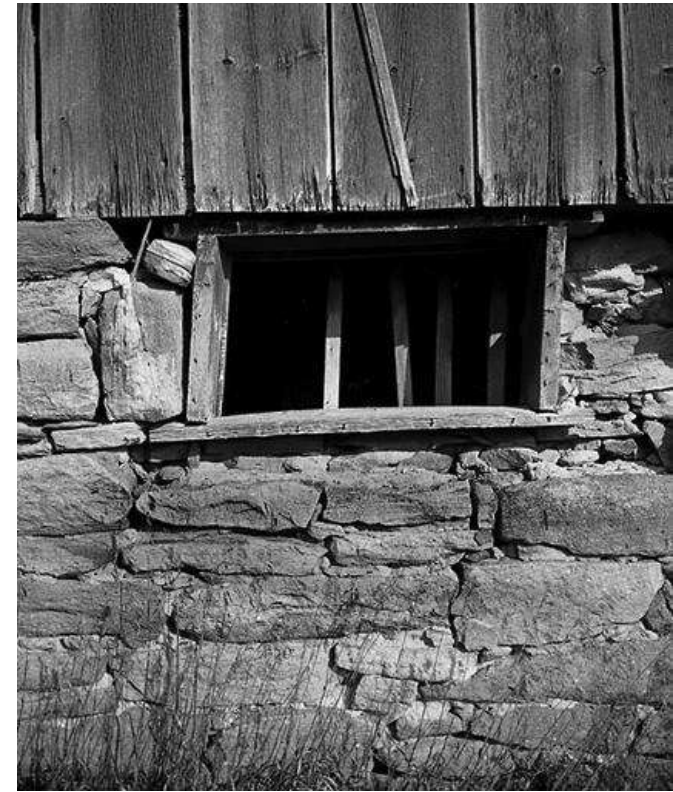
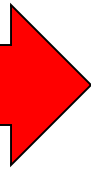

FOUNDATIONS

RUBBLE

FIELD STONE

DRESSED STONE

BRICK

CLAY TILE

CONCRETE BLOCK

POURED CONCRETE

POSTS

PIERS

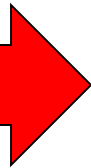

FOUNDATIONS

- RUBBLE
- FIELD STONE
- DRESSED STONE
- BRICK**
- CLAY TILE
- CONCRETE BLOCK
- POURED CONCRETE
- POSTS
- PIERS

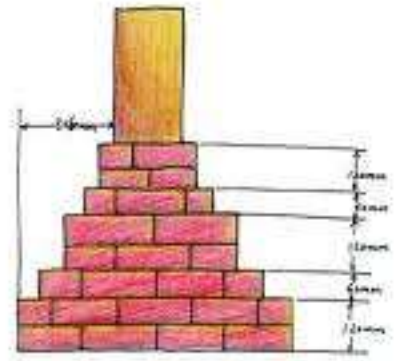
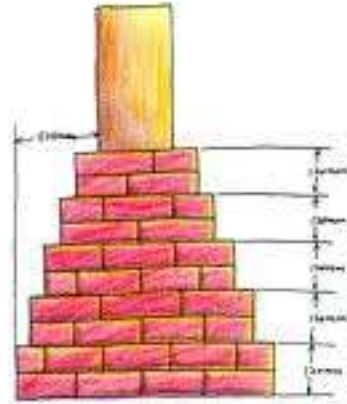
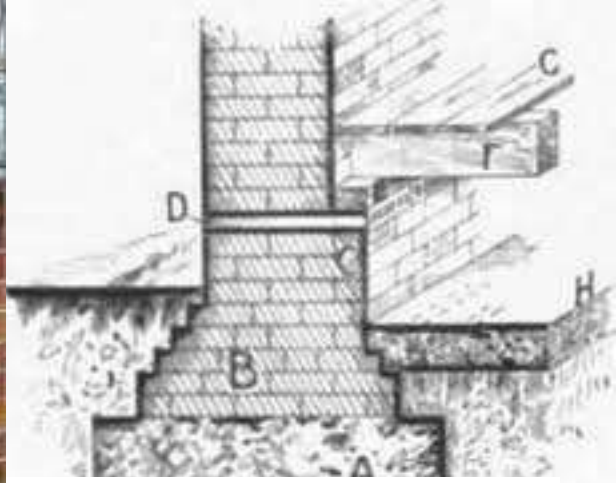

FOUNDATIONS

RUBBLE
FIELD STONE
DRESSED STONE
BRICK

CLAY TILE 
CONCRETE BLOCK
POURED CONCRETE

POSTS
PIERS

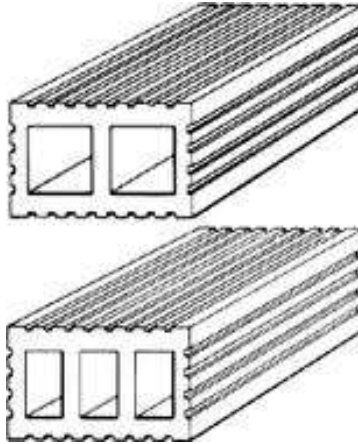

FOUNDATIONS

- RUBBLE
- FIELD STONE
- DRESSED STONE
- BRICK
- CLAY TILE
- CONCRETE BLOCK**
- POURED CONCRETE
- POSTS
- PIERS

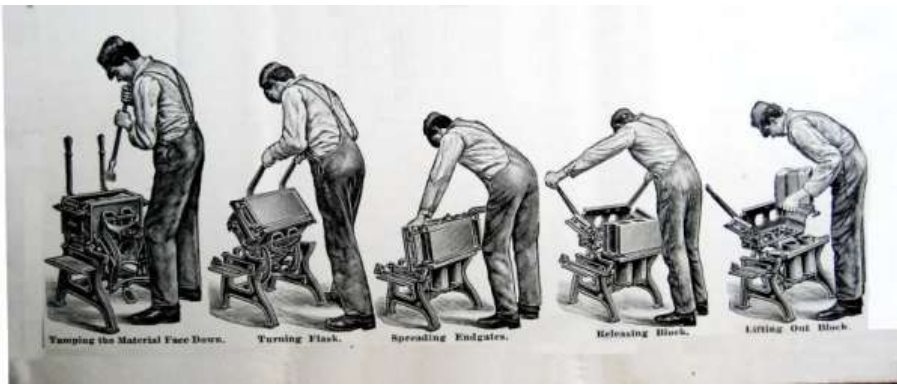

\$57.50 Wizard Block Making Outfit
Includes 20 Iron Molds

The Wizard Block Making Outfit is a compact, efficient machine for producing concrete blocks. It is designed for use in small workshops or on construction sites. The outfit includes 20 iron molds, which are used to shape the concrete into various block sizes and shapes. The machine is easy to operate and produces blocks that are uniform in size and shape.

Block Size	Price
8" x 8" x 16"	\$1.25
8" x 12" x 16"	\$1.50
12" x 12" x 16"	\$1.75
12" x 16" x 16"	\$2.00
16" x 16" x 16"	\$2.25
16" x 20" x 16"	\$2.50
20" x 20" x 16"	\$2.75
20" x 24" x 16"	\$3.00
24" x 24" x 16"	\$3.25
24" x 28" x 16"	\$3.50
28" x 28" x 16"	\$3.75
32" x 28" x 16"	\$4.00
36" x 28" x 16"	\$4.25
40" x 28" x 16"	\$4.50
44" x 28" x 16"	\$4.75
48" x 28" x 16"	\$5.00
52" x 28" x 16"	\$5.25
56" x 28" x 16"	\$5.50
60" x 28" x 16"	\$5.75

FRANK BISHOP AND CO. CHICAGO



FOUNDATIONS

- RUBBLE
- FIELD STONE
- DRESSED STONE
- BRICK
- CLAY TILE
- CONCRETE BLOCK
- POURED CONCRETE**
- POSTS
- PIERS

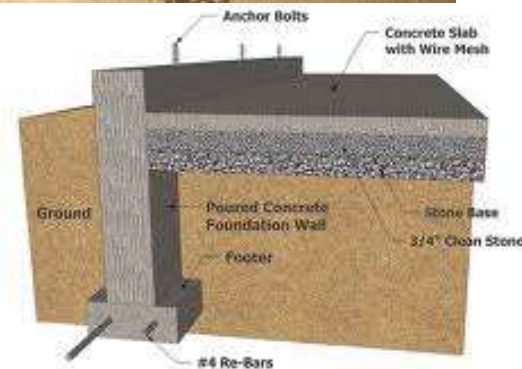

FOUNDATIONS

- RUBBLE
- FIELD STONE
- DRESSED STONE
- BRICK
- CLAY TILE
- CONCRETE BLOCK
- POURED CONCRETE
- POSTS**
- PIERS

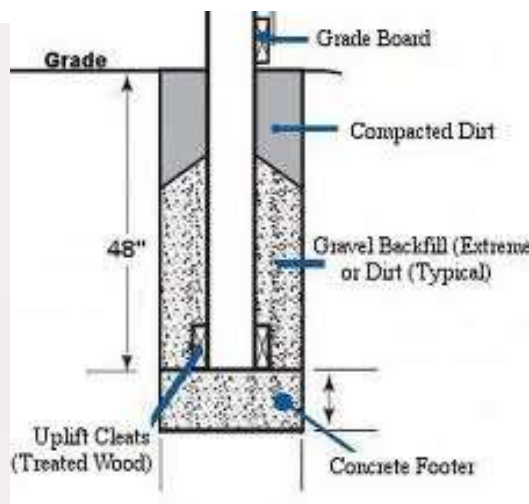
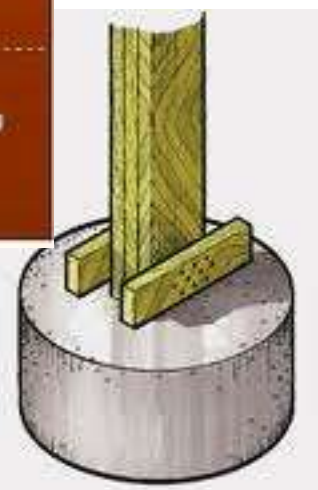
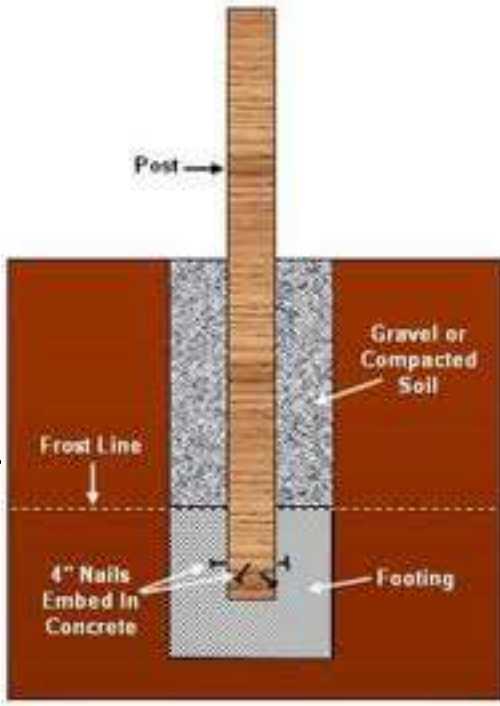
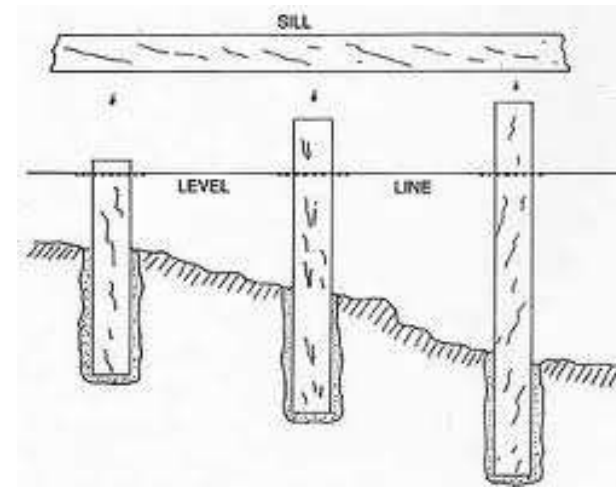

FOUNDATIONS

- RUBBLE
- FIELD STONE
- DRESSED STONE
- BRICK
- CLAY TILE
- CONCRETE BLOCK
- POURED CONCRETE
- POSTS
- PIERS**

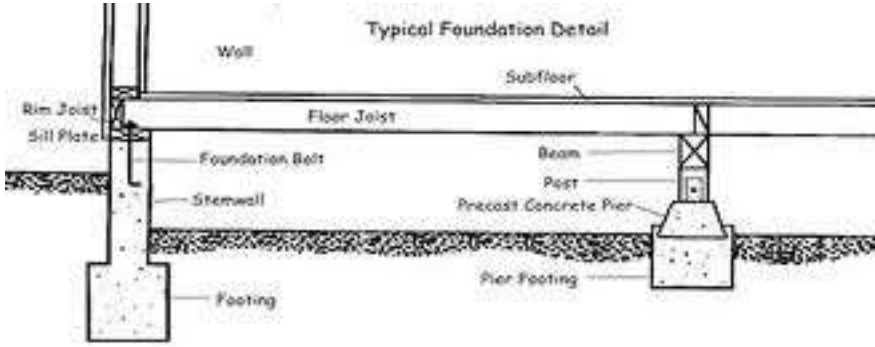



Foundations

Walls



Clay Tile





**Why Use Clay
Tile?**

FRAMING

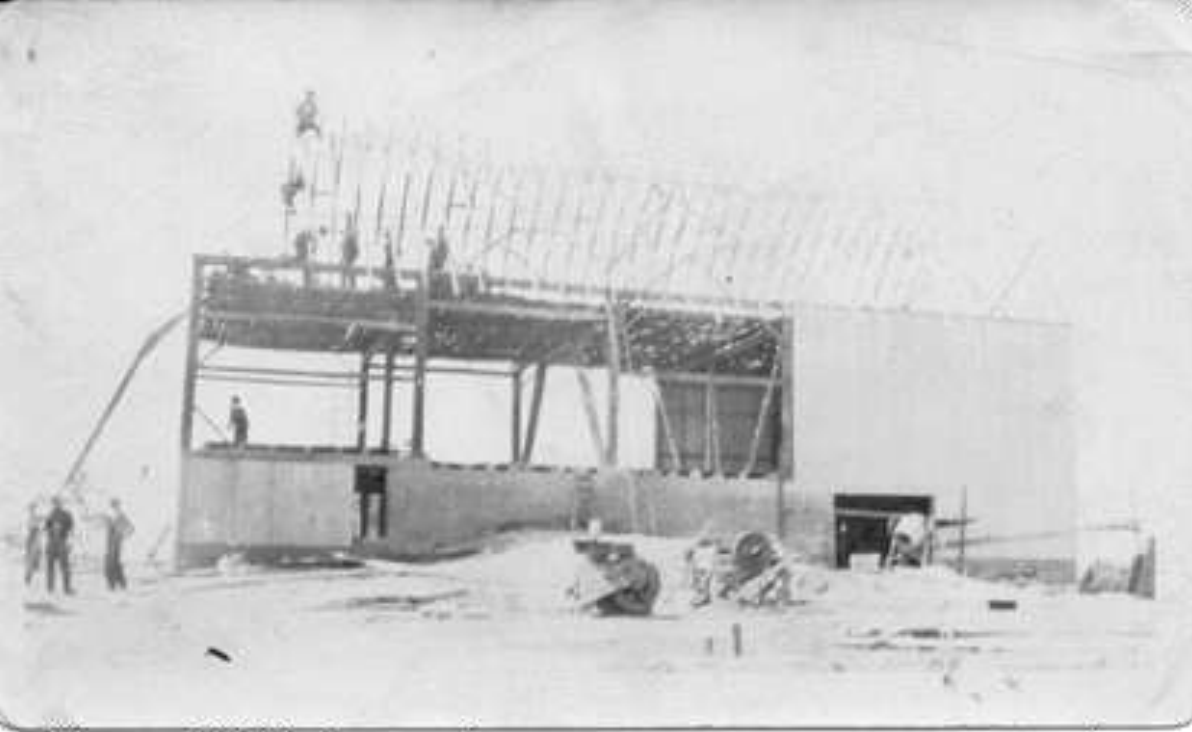

1928 Barn Raising



INNOVATION



Using Tin on Barns



Using Tin on Everything



OLDER MINNESOTA BARNNS

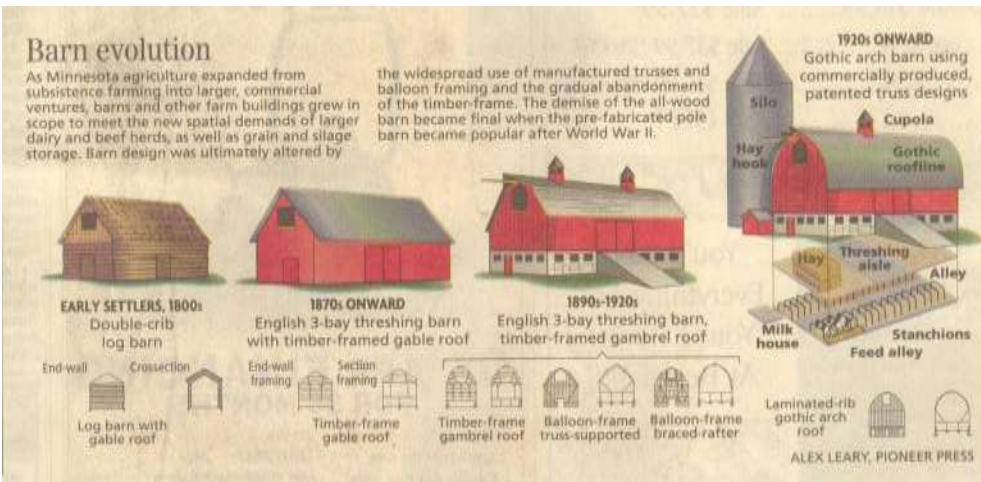





Barn evolution

As Minnesota agriculture expanded from subsistence farming into larger, commercial ventures, barns and other farm buildings grew in scope to meet the new spatial demands of larger dairy and beef herds, as well as grain and silage storage. Barn design was ultimately altered by

the widespread use of manufactured trusses and balloon framing and the gradual abandonment of the timber-frame. The demise of the all-wood barn became final when the pre-fabricated pole barn became popular after World War II.

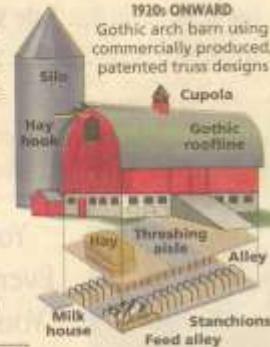

EARLY SETTLERS, 1800s
Double-crib log barn



1870s ONWARD
English 3-bay threshing barn with timber-framed gable roof



1890s-1920s
English 3-bay threshing barn, timber-framed gambrel roof

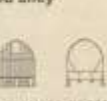
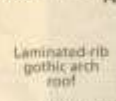

ALEX LEARY, PIONEER PRESS



Barn evolution

As Minnesota agriculture expanded from subsistence farming into larger, commercial ventures, barns and other farm buildings grew in scope to meet the new spatial demands of larger dairy and beef herds, as well as grain and silage storage. Barn design was ultimately altered by

the widespread use of manufactured trusses and balloon framing and the gradual abandonment of the timber frame. The demise of the all-wood barn became final when the pre-fabricated pole barn became popular after World War II.



EARLY SETTLERS, 1800s
Double-crit log barn



1870s ONWARD
English 3-bay threshing barn with timber-framed gable roof



1890s-1910s
English 3-bay threshing barn, timber-framed gambrel roof

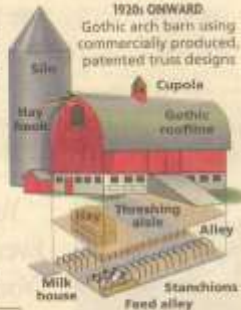

1920s ONWARD
Gothic arch barn using commercially produced, patented truss designs.



Log barn with gable roof



Timber-frame gable roof



Timber-frame gambrel roof



Balloon-frame truss-supported



Balloon-frame braced-rafter

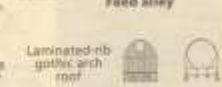

Laminated-rib gothic arch roof

ALEX LEARY, PIONEER PRESS



HOW TO HELP

If you would like to help start a grass-roots organization to preserve barns, call John Lauber at the State Historic Preservation Office at (651) 297-4418.

FROM PAGE 1C

Razing barns

(continued)

Minnesota's first grass-roots barn preservation group is trying to get off the ground.

A SYMBOL OF THE PAST

Anecdotal evidence of barns leaving the landscape is plentiful, but a Minnesota Historical Society study last year put hard numbers to the trend.

The study estimates the number of historic barns in Minnesota fell 75 percent from 1930 to 2000. In 1987, there were 68,850; in 2000, there were 51,350. Recent losses have been estimated at nearly 2 percent — about 1,000 — a year.

Most old barns are functionally obsolete, said University of Minnesota geography professor John Fraser Hart, who concentrates on rural areas.

"There won't be any around in 20 years," he said. "Eventually it will fall down, it will be burned down or it will be torn down."

Old barns

Doug Ohman has photographed more than 1,000 barns, mostly in Minnesota. "I see more of them disappearing every year, and I think it's important we save them, at least through photographs," said Ohman, owner of Pioneer Photography in New Hope. "I like them because they speak to the everyday American. They're not pretentious in any way." The Pioneer Press asked Ohman to pick five of his favorite historic barns that aren't too far from the metro area.

ROUND BARN



PHOTOS BY DOUG OHMAN

Scott County: On County Road 2, a couple miles west of New Market.

DAIRY BARN



Hennepin County: It's the largest dairy barn in the county. On County Road 50 north of Loretto.

RAILROAD BARN



Anoka County: It's on Minnesota 47, about six miles north of Anoka. The Northern Pacific Railroad built it, and it served as a stagecoach stop for the night.

CARRIAGE BARN



Dakota County: It's in Hastings on U.S. 61 at the LeDuc Historic Site, which is expected to open to the public in 2005.

OLD ENGLISH



Sherburne County: It's a red barn, circa 1880. Just off U.S. 10, north of Becker.

PIONEER PRESS

Weddings, birthday parties, family reunions and meetings are held in the barn at The Fields of St. Croix. "It creates value for home buyers. That's where some people may be missing an opportunity by knocking them down: It does become a gathering place and a community focus. It's invaluable as far as community building."

ROBERT ENGSTROM

President of Robert Engstrom Cos., which developed The Fields of St. Croix in Lake Elmo





CITY OF
MAPLEWOOD
PROPERTY
Access by Special
Arrangement.
Call: 778-7183

SPECIAL FEATURES ON BARNNS

CUPOLA

LIGHTNING ROD

HAY LIFT

WINDOWS

DOOR

MILK HOUSE

RAMP

ELEVATOR

HAY PEAK

CUPOLA



WINDOWS



Hay Mow Doors

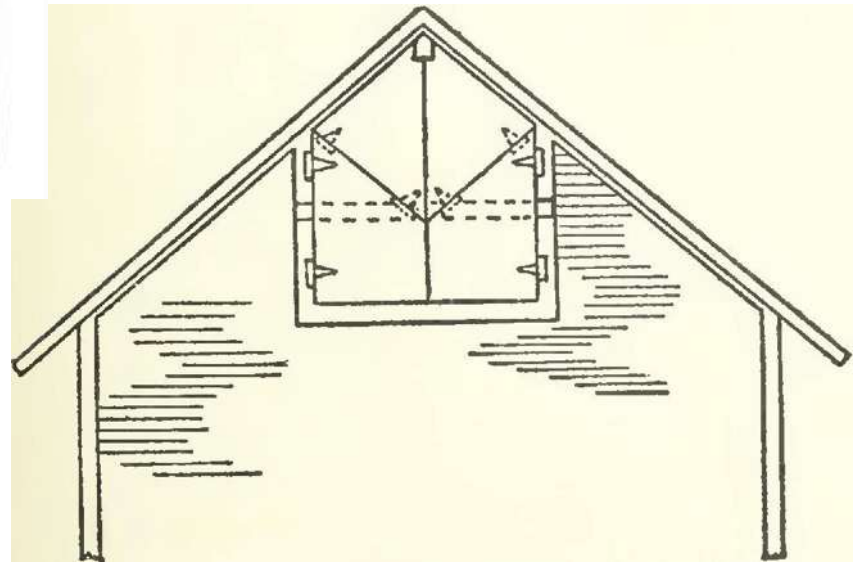
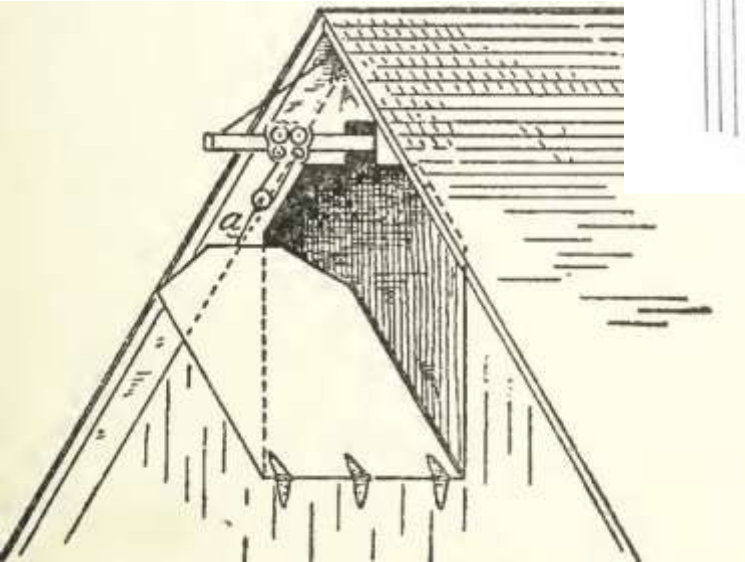
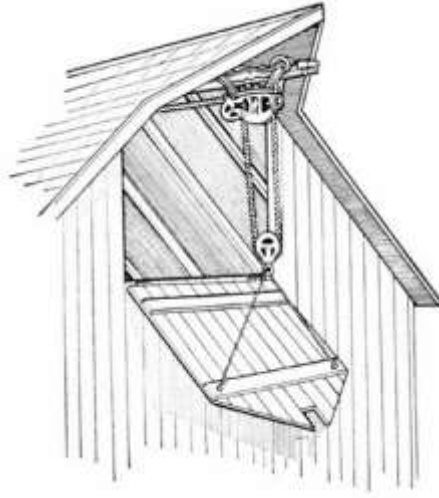
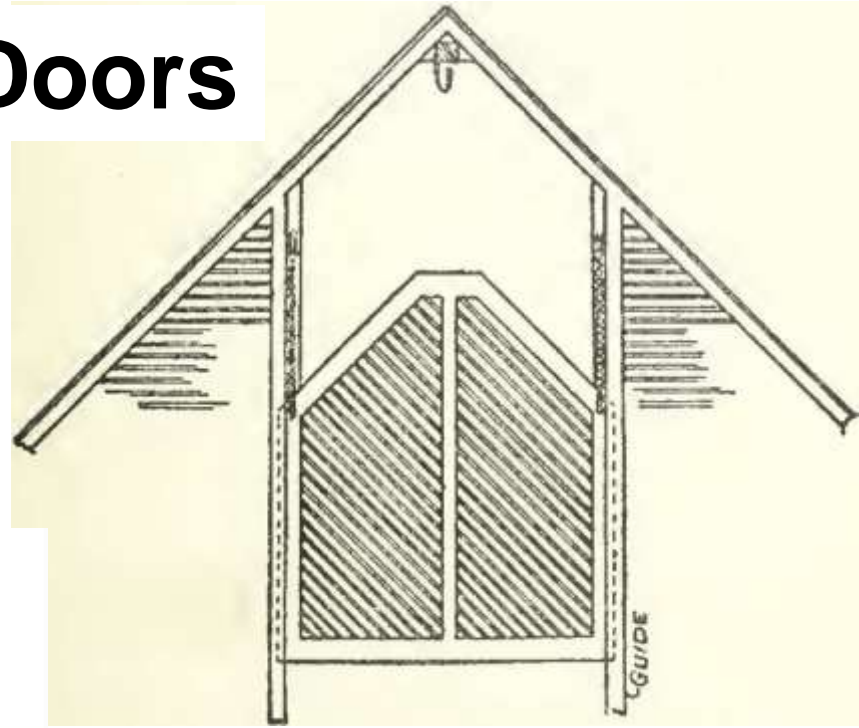
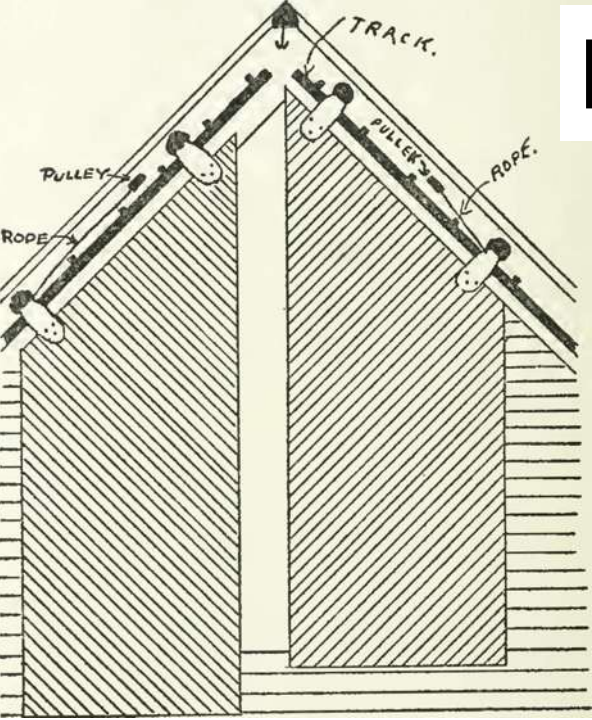



Hay Mow Doors





HAY PEAK STYLES



MODIFIED BARN





Additions to the Original Barn



**Which Lasts
Longer....**

**Old Barn
or
New Addition?**







What's wrong with this Barn?

What's wrong with using this Barn?



New Uses?



New Uses?





New Uses?



CARCASSES ON THE PRAIRIE





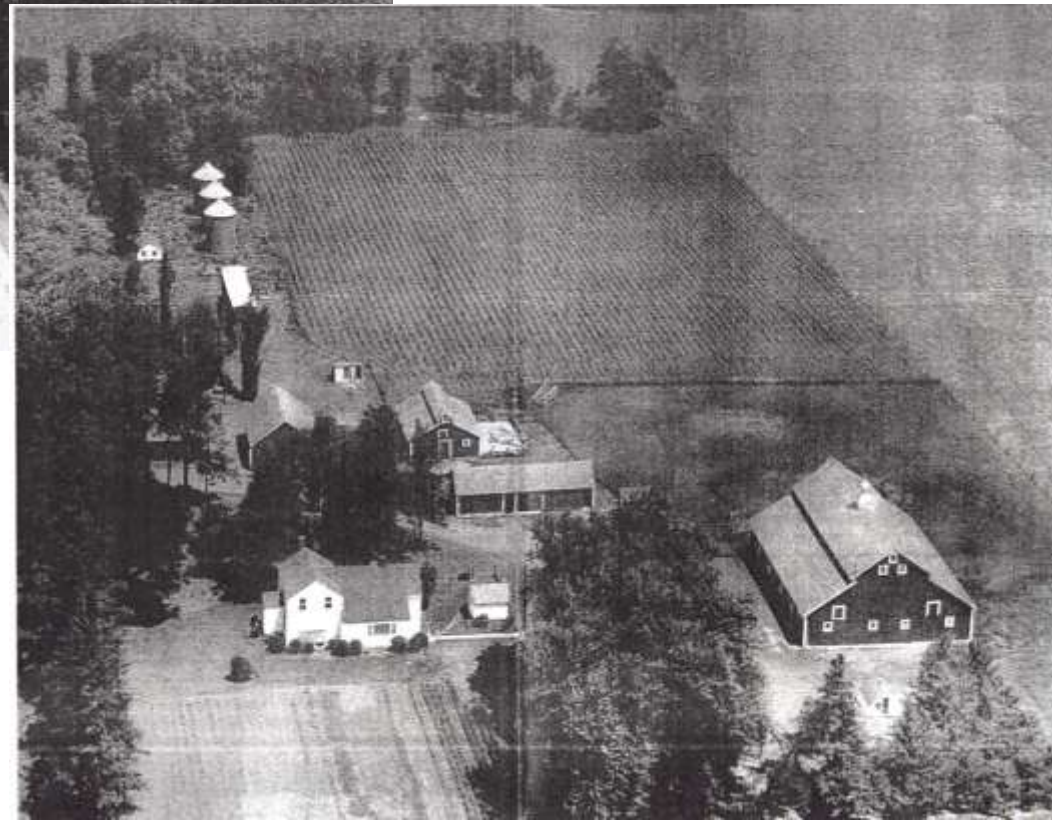

Which is 1950's?

Which is 1990's?

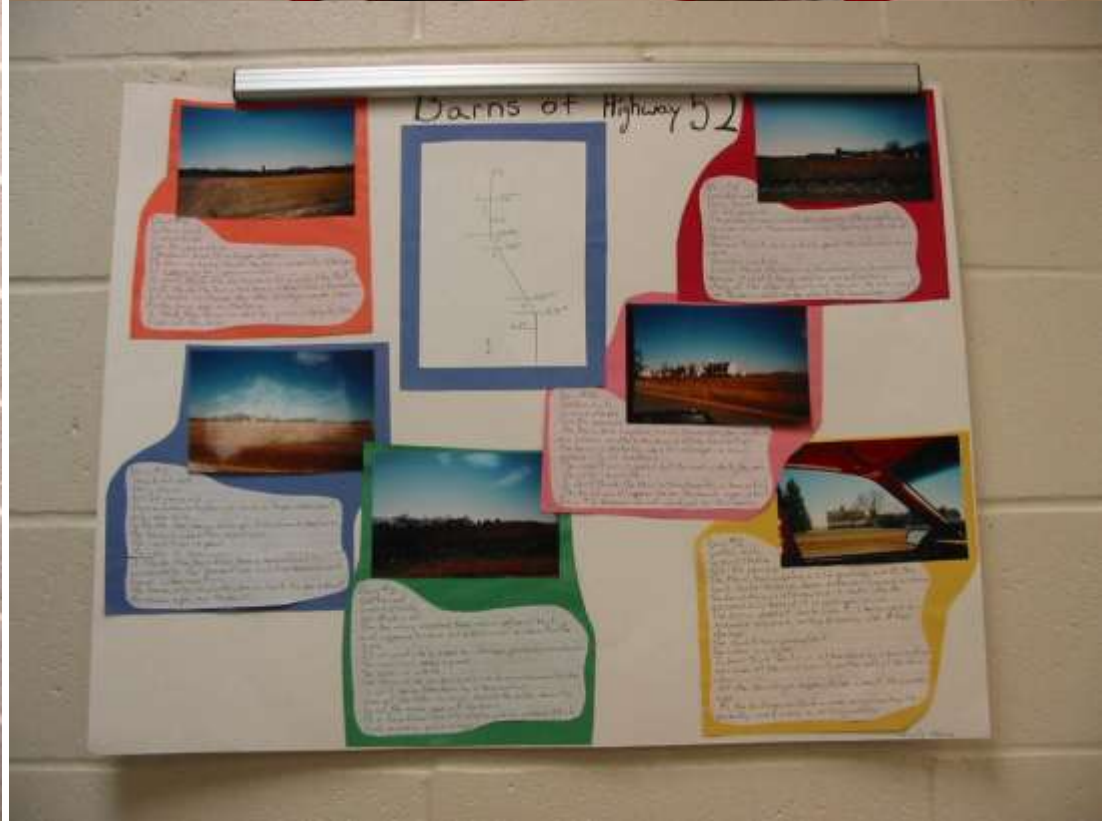









FAIRVIEW

FARM RESIDENCE OF R.S. HERSHEY, 5 MILES SOUTH OF DITCHFIELD, MEeker CO., MINN.

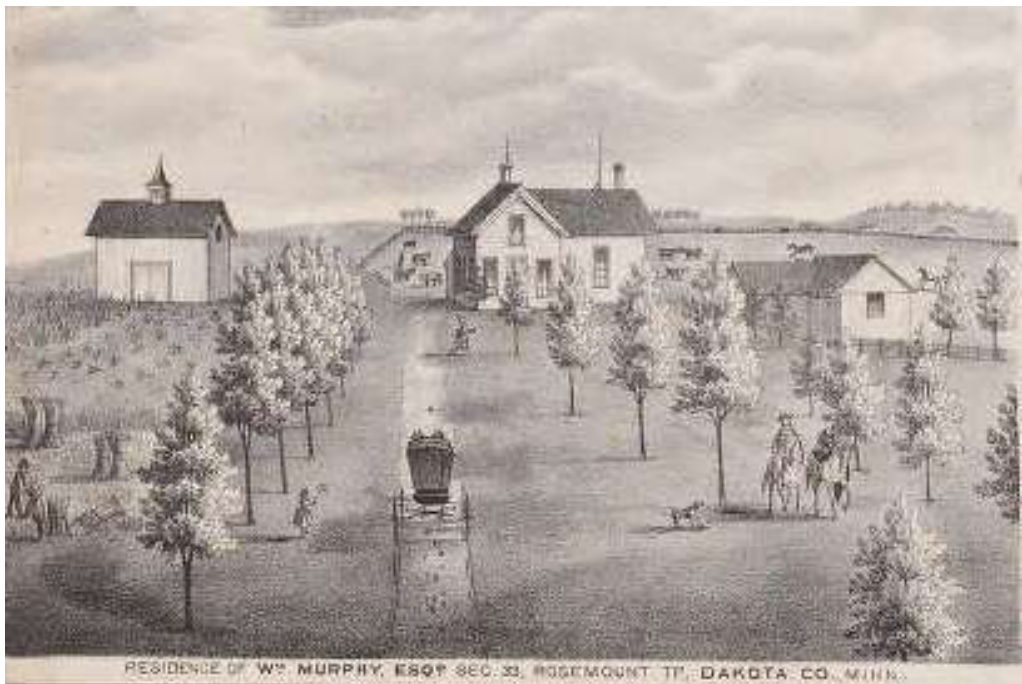

RESIDENCE OF W. MURPHY, ESQ. SEC. 33, ROSSEMOUNT TP., DAKOTA CO., MINN.



RESIDENCE OF GEO. C. CHAMBERLIN, WATERFORD TOWNSHIP, DAKOTA CO., MINN.



RESIDENCE OF GEO. W. GLEASON, DANFORD TP., DODGE CO., MINN.



FARM RESIDENCE OF C. H. STINCHFIELD, SEC. 24, CEDAR MILLS TP. MEeker CO.



RESIDENCE OF J. M. WALDREN, LITCHFIELD MINN.



PREMISES OF A. MASTENBROCK, DANFORD TP. DODGE CO. MINN.